

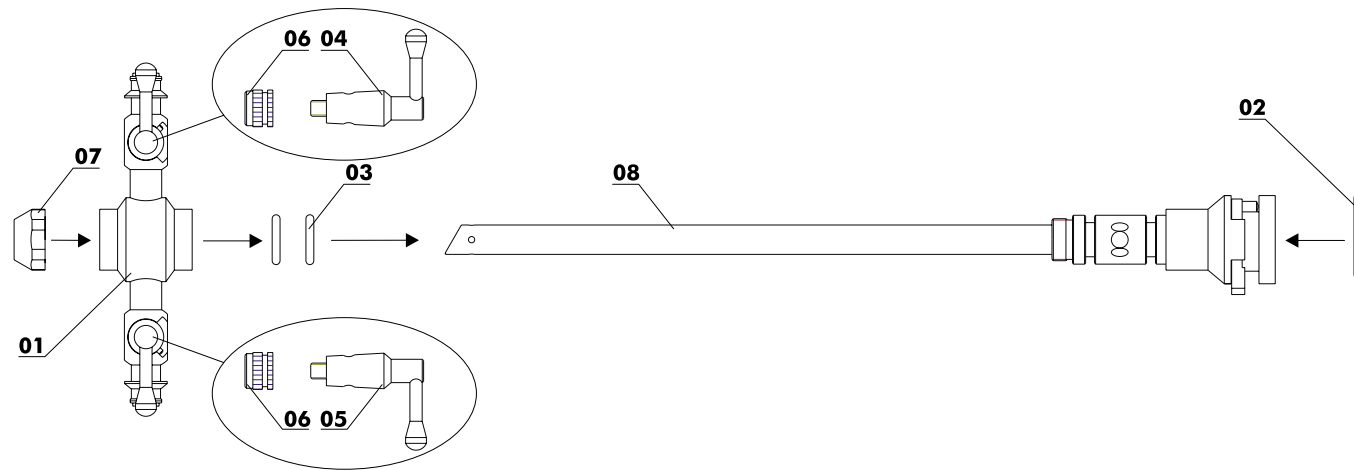

CE 0483

ORIHOMEDICAL
G m b H · I M P L A N T S

The **ORIHOMEDICAL** Stryker-Arthroscopy Sheath with two rotating stopcocks ASS



- 01** Hub Ring with 2 Stopcocks **07** Serrated Ring
- 02** O-Ring **08** Arthroscopy Sheath
- 03** O-Ring
- 04** Stopcock left
- 05** Stopcock right
- 06** Spring Cap

CLEANING / STERILIZATION

Immediately after use the instruments have to be soaked in a combined disinfection and cleaning solution in order to prevent operation residues to dry on and a transmission of germs in the endoscopy rooms. Cleaning agents and disinfection solution have to match. Please observe the respective guidelines for these substances. The instruments have to undergo a thorough cleaning process, because detergents, blood, pus, and protein residues may influence

Field of use - Stryker-Arthroscopy Sheath

The term „arthroscopy“ derives from the classical Greek language. Thereby, the term “arthros” refers to the joint, “scopy” means to look.

Arthroscopy is generally used for examinations of injuries of the knee, shoulder, hand and ankle joints as well as unclear constant joint pains.

Our versions differ in diameter (Ø 1.7 mm, 2.0 mm, 2.4 mm, 4 mm and 5 mm) and length. We adapt them so that they are compatible with the common optics of various manufacturers.

the disinfection and sterilization procedure. After the cleaning procedure, all moving parts have to be oiled. All revolving stop cocks and pistons have to be lubricated. We recommend our lubricator RFP 00199.

Proper care and service are necessary for the safe use of medical products. We therefore recommend a thorough check of function, completeness and damages (especially porous and cracked rubber and plastic parts), sharp edges and rough surfaces.

Disassembly of Stryker-Arthroscopy Sheath

Please, disassemble only pre-washed instruments.

Unscrew the knurled nut 07 and pull it off together with the hub ring 01. Screw off the two spring caps 06 and remove the valves 04 and 05 from the stopcocks. Press the lock of the arthroscopy shaft 08 and pull off O-ring 02.

The Arthroscopy-Sheath is now completely disassembled.

Assembly of Stryker-Arthroscopy Sheath

First, slide the hub ring 01 with the stopcock guidance onto the arthroscopy shaft 08 and screw on the knurled nut 07. **When inserting the valves 04 and 05 into the stopcocks, please make sure that the guiding pins run in the guidance and that the lever (in open position) shows to the opening.** Screw the valves 04 and 05 onto the spring caps. Slide O-ring 02 onto the case of the arthroscopy shaft 08.

Check the instrument for proper function.

The Arthroscopy-Sheath is now completely assembled.

Stryker-Arthroscopy Sheath ASS

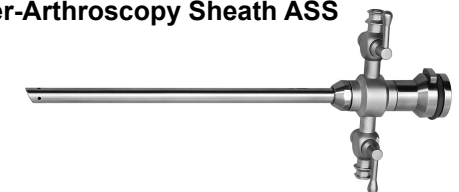

Please pay attention to our general information for Care, Maintenance and Cleaning GA-001.